

## Pt100 sensor Y thermowell, flange and terminal head

### Model 7860000, built on order

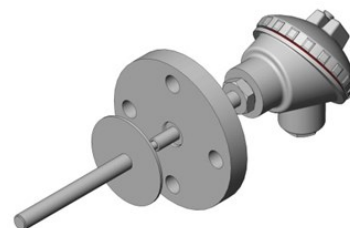

#### Design

The measurement insert consists of flange and terminal head and is intended to be used with a so called Y thermowell. The thin flange of the thermowell is to be squeezed between the sensor's flange and the flange of the process vessel.  
Replaceable insertion probe.

#### Example of use

The thermowell is usually used to protect the sensor from chemically aggressive environments.

#### Max.temp.

Measuring probe: 250 °C or 600 °C depending on probe construction.

#### Probe insert, replaceable

| Pt100 resistor (IEC 60751) | Model   | Max. Temp. |
|----------------------------|---------|------------|
| Pt100 A                    | 7264001 | 250 °C     |
| Pt100 1/3 DIN              | 7264200 | 600 °C     |
| Pt100 1/5 DIN              |         |            |
| Pt100 1/10 DIN             |         |            |

Diameter: Adjusted to the measures of the Y thermowell.  
Length = L1+L2+27 mm

#### Y thermowell

| Ø d, mm       | Material         |
|---------------|------------------|
| 10, 12, 13,72 | Hasteloy. C-276: |
| 10, 12        | Titanium Gr2     |
| On request    | Tantalum         |

#### Process connection

Flange according to EN 1092-1  
Material: EN1.4404/1.4432/1.4435

| Dimension                                       | Pressure class               |
|---|------------------------------|
| DN10...DN150                                    | PN16 (=PN10)<br>PN40 (=PN25) |
| DN200...DN300                                   | PN10, PN16, PN25, PN40       |
| For other alternatives please contact Pentronic |                              |

#### Terminal head

Adjustable head.  
Cable gland M20x1.5.

| Type  | Lid                       | Material                      |
|---|---------------------------|-------------------------------|
| DNAG  | Screw-on lid              | Grey lacquered aluminium      |
| Form B  | Lid fixed with two screws | Grey lacquered aluminium      |
| DAN   | Hinge lid                 | Grey lacquered aluminium      |
| BBK   | Screw-on lid              | Glass fiber armoured Polyamid |
| SEG   | Screw-on lid              | Stainless steel               |
| DADAWdie  | Lid with LED display      | Grey lacquered aluminium      |
| For other alternatives please contact Pentronic |                           |                               |

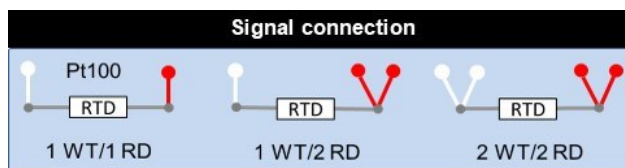

| Connection options |
|--------------------|
| Stripped wires     |
| Transmitter        |
| Terminal block     |

#### Certificate

Test value: Certificate EN10204 3.1

*For advice, please contact Pentronic*