

## Pt100 sensor Protection tube, flange and terminal head

### Model 7850000, built on order

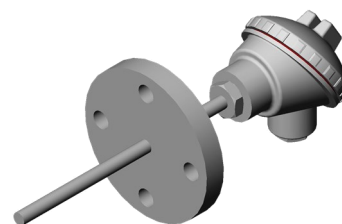

#### Design

Outer protection tube, flange and terminal head.  
Replaceable insertion probe.

#### Example of use

Temperature measurements of gasses and liquids.

#### Max.temp.

Probe: 250 or 600 °C depending on design of insertion probe.

#### Replacement insertion probes

Pt100 element (IEC 60751)	Model	Max Temp
Pt100 A	7264001	250 °C
Pt100 1/3 DIN	7264200	600 °C
Pt100 1/5 DIN		
Pt100 1/10 DIN		

Diameter: To be fitted for the protection tube.  
Length = L1+L2+27 mm

Housing/Protection, tube Ø d	Material, stainless steel
10 mm	EN 1.4435
12 mm	EN 1.4435
15 mm	EN 1.4435
For other alternatives please contact Pentronic	

Process connection		
Material: EN 1.4404/1.4432/1.4435		
Dimension	Pressure class	Flange standard
Flange DN10... DN150	PN16 (=PN10) PN40 (=PN25)	EN 1092-1
Flange DN200... DN300	PN10, PN16, PN25, PN40	EN 1092-1
Flange 1", 1½"	150lbs, 300lbs	ASME B16.5
Flange 2"	150lbs, 300lbs, 600lbs	ASME B16.5
For other alternatives please contact Pentronic		

#### Terminal head

Adjustable head.  
Cable gland M20x1.5.

Type	Lid	Material
DNAG	Screw-on lid	Grey lacquered aluminium
Form B	Lid with fastening screws	Grey lacquered aluminium
DAN	Hinge lid	Grey lacquered aluminium
BBK	Screw-on lid	Glas fiber armoured Polyamid
SEG	Screw-on lid	Stainless steel
DADAWdie	Lid with LED display	Grey lacquered aluminium
For other alternatives please contact Pentronic		

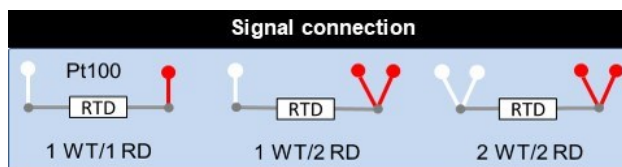

Connection options
Stripped wires
Transmitter
Terminal block

#### Certificate

Test value: Certificate EN10204 3.1

#### Dimensions

L1 and L2 as required.

*For advice, please contact Pentronic*